

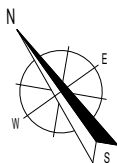

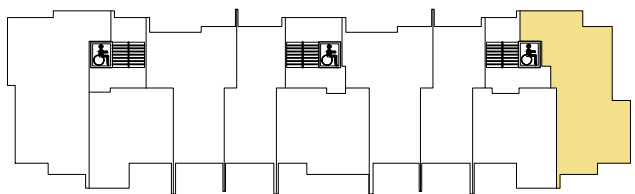



# OSIEDLE JAGIELŁY

## PIĘTRO I SCHEMAT KONDYGNACJI



-  ETAP: III
-  MIESZKANIE NR: 4
-  PIĘTRO: PIĘTRO I  
KONDYGNACJA NAZIEMNA: 2
-  LICZBA POKOI: 3
-  POWIERZCHNIA: 68,42 m<sup>2</sup>
-  POW. BALKONU: 16,92 m<sup>2</sup>

LOKAL 4		
1.4/1	PRZEDPOKÓJ	8,12
1.4/2	SYPIALNIA	16,22
1.4/3	SYPIALNIA	9,65
1.4/4	ŁAZIENKA	5,58
1.4/5	POKÓJ DZIENNY Z ANEKSEM KUCHENNYM	28,85
POWIERZCHNIA LOKALU 4		68,42

### PLAN OSIEDLA

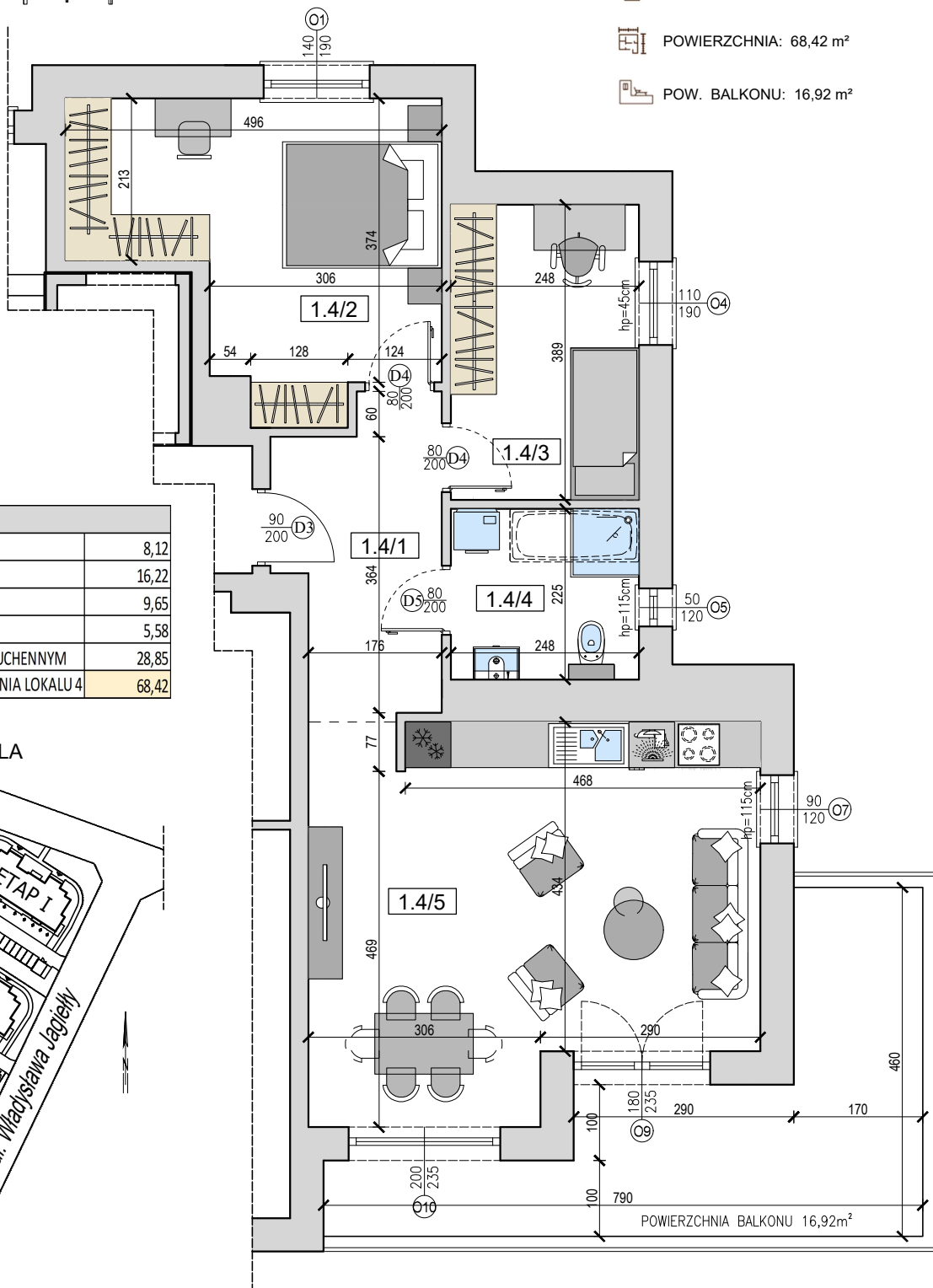
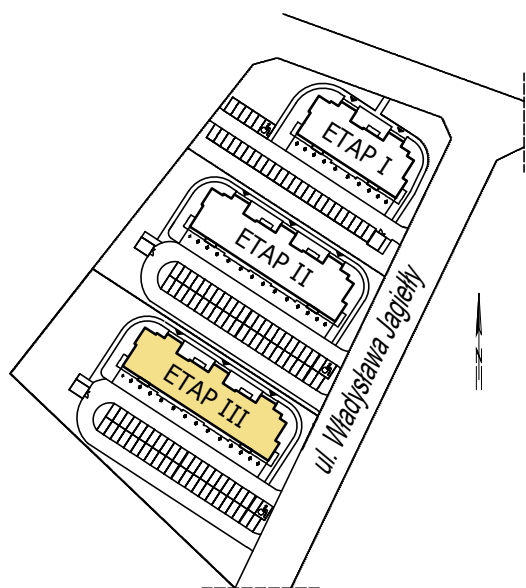

### Biuro Sprzedaży

 ul. Wł. Łokietka 6,  
86-100 Świecie

  
**APARTADO**  
DEVELOPMENT

 +48 504 504 470

 biuro@apartado.pl

 www.apartado.pl