

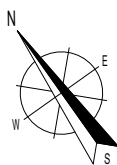





OSIEDLE JAGIELŁY



-  ETAP: III
-  MIESZKANIE NR: 20
-  PIĘTRO: PIĘTRO I
KONDYGNACJA NAZIEMNA: 2
-  LICZBA POKOI: 2
-  POWIERZCHNIA: 49,74 m²
-  POW. BALKONU: 12,49 m²

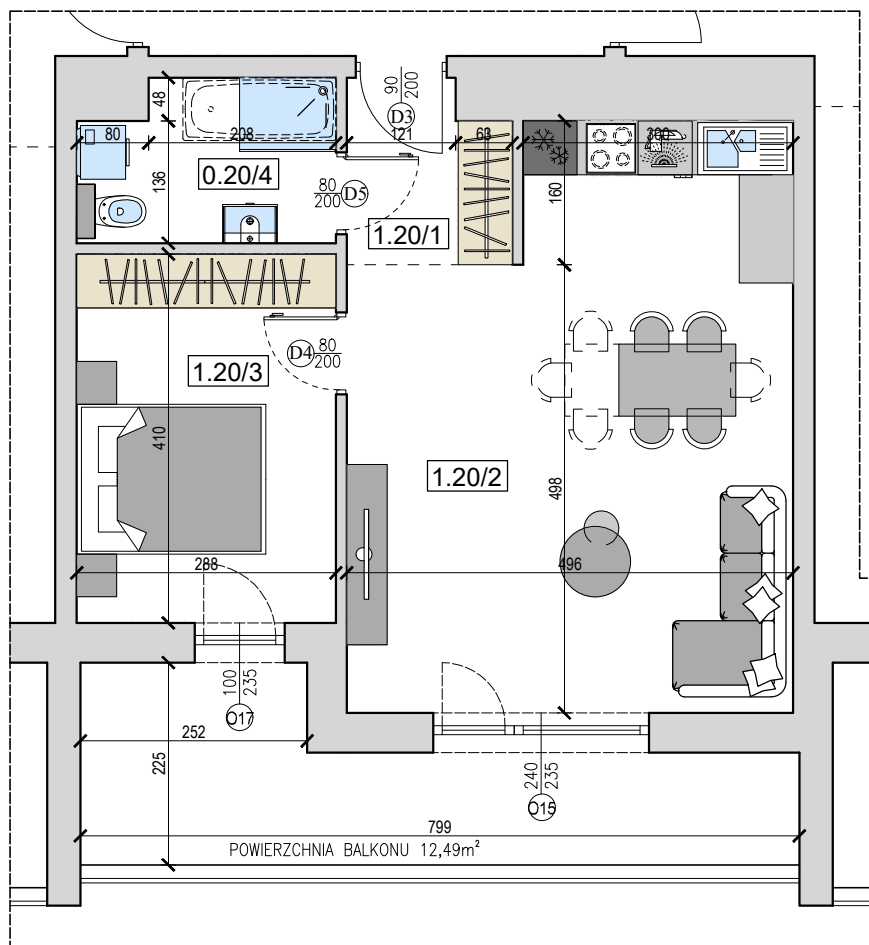

| LOKAL 20 | | |
|------------------------|-----------------------------------|-------|
| 1.20/1 | PRZEDPOKÓJ | 3,52 |
| 1.20/2 | POKÓJ DZIENNY Z ANEKSEM KUCHENNYM | 29,5 |
| 1.20/3 | SYPIALNIA | 11,81 |
| 1.20/4 | ŁAZIENKA | 4,91 |
| POWIERZCHNIA LOKALU 20 | | 49,74 |

PIĘTRO I
SCHEMAT KONDYGNACJI

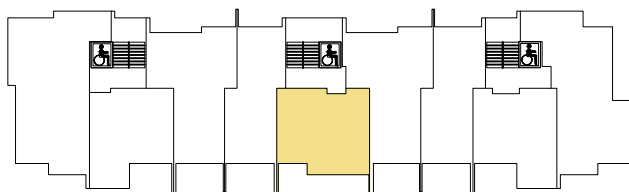

PLAN OSIEDLA

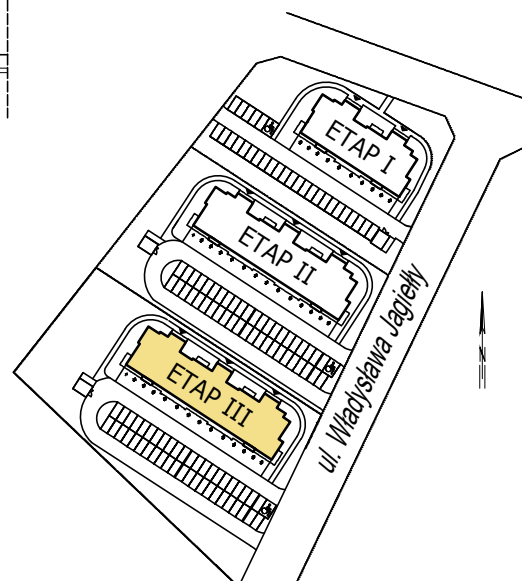

Biuro Sprzedaży

 ul. Wł. Łokietka 6,
86-100 Świecie

APARTADO
DEVELOPMENT

 +48 504 504 470

 biuro@apartado.pl

 www.apartado.pl